

Ultra Flip Swivels successfully tested by RINA



We are pleased to inform you that our Ultra Flip Swivel has recently achieved RINA Certification. This RINA Certification confirms the very high breaking loads which we have been communicating in the past already. Now we have further confirmation of the superb quality of the Ultra Flip Swivels along with the ABS certification of our Ultra Anchors.

In light of this new certification and in order to communicate the functionality of the swivels more easily, we have decided to change the names of our Flip Swivels.

New Swivel naming:

Attached you will find an updated Ultra Flip Swivel selection chart and also an explanation of the new naming. Basically we have no more UFS+H10, but now we have UFS10-35. Where the "10" still has the same meaning (max. chain size) and "35" simply describes the maximum Ultra Anchor weight. Packaging will remain same.

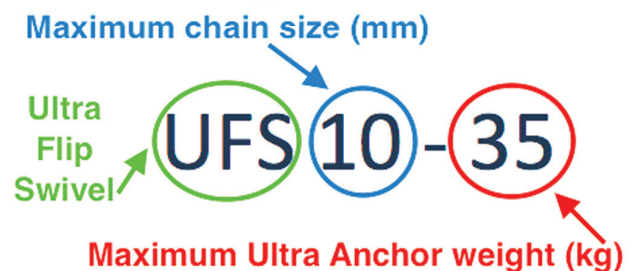

Kindly update your records accordingly with the attached price list and Ultra Flip Swivel selection chart.

(RINA certificates are available on request)

Kind regards,
Ultra Marine Europe s.r.o.

Contact details:

ULTRA MARINE EUROPE s. r. o.
Jankovcova 1587/8, Prague, Czech Republic
T: +420 283 870 032, E: info@ultramarine-anchors.com

Contact person:

Jan Langsadl
M: +420 603 920 777, E: jan@ultramarine-anchors.com

Flip Swivel

top view

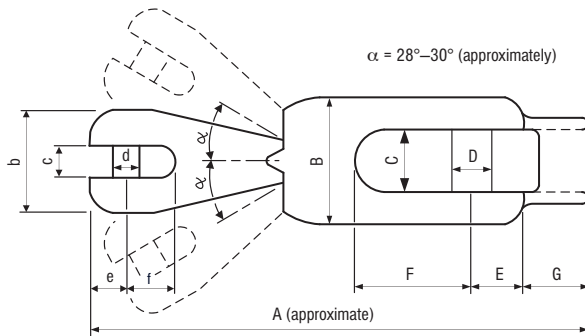

side view

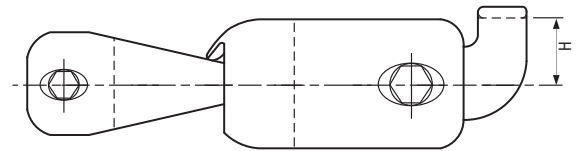

TYPE #	CHAIN DIAMETER		WHOLE LENGTH APPROXIMATELY A	chain part dimensions b×c×d×e×f	ANCHOR PART DIMENSIONS B×C×D×E×F	FLIPPING BRIDGE DIMENSIONS G×H	BREAKING LOAD (*)		MAXIMUM ANCHOR WEIGHT
	mm	inch					kN	lbf	
UFS 6-12	6	1/4"	121	25×7,6×7×9×11	35×16×11×13×31	14×17	38,4	8640	12
	6	1/4"							
UFS 8-21	8	5/16"	147,5	30×9,4×9×11×14,5	40×19×13×16×36,5	18,5×20	56,7	12740	21
	8	5/16"							
UFS 10-35	10	3/8"	168	35×11,6×11×13×17	45×21×14,5×18×40	21×22,5	90,7	20400	35
	10	3/8"							
UFS 13-60	12	1/2"	211,5	45×15,2×14,5×16,5×23	55×26×18×23×51,5	26,5×30	160,9	36200	60
	13	1/2"							
UFS 16-100	12	1/2"	250	53×18,2×18×20×27	65×31×22×27×59	33×36	236,5	53200	100
	13	1/2"							
UFS 20-160	14	5/8"	309	65×23×22×26×34	85×40×26×32×72	40×40,5	321,5	72300	160
	14	5/8"							
UFS 26-250	16	5/8"	364	85×30×26×33×43	110×48×32×40×77	48×56	474,8	106700	250
	16	5/8"							
UFS 32-360	18	3/4"	475	110×38×32×43×55	140×66×40×52×99	68×60	726	163047	360
	18	3/4"							
UFS 32-360	20	3/4"	475	110×38×32×43×55	140×66×40×52×99	68×60	726	163047	360
	20	3/4"							
UFS 32-360	23	1"	475	110×38×32×43×55	140×66×40×52×99	68×60	726	163047	360
	23	1"							
UFS 32-360	26	1"	475	110×38×32×43×55	140×66×40×52×99	68×60	726	163047	360
	26	1"							
UFS 32-360	30	1 1/4"	475	110×38×32×43×55	140×66×40×52×99	68×60	726	163047	360
	30	1 1/4"							
UFS 32-360	32	1 1/4"	475	110×38×32×43×55	140×66×40×52×99	68×60	726	163047	360
	32	1 1/4"							

(*) – Tested by RINA (except UFS 32-360).

– Safe Working Load = 0,5 × Breaking Load.

– UFS selection should be based on the "Max. Anchor Weight". If the "Max. Anchor Weight" is not enough, one size bigger UFS should be selected.

– One size bigger UFS can also be used with the same chain. Therefore one size bigger swivel should be selected for chains such as Grade 70 (G7).

– Custom ones without the flipping bridge and flipping nub could also be made for symmetrical stockless anchors.

– When noted with the order, modified ULTRA Flip Swivels adaptable to smaller size chains than the listed ones could be made.